

BASINS

Ceramic

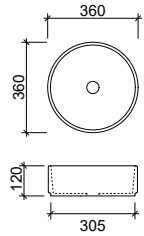

Allure

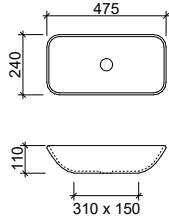

Bloom

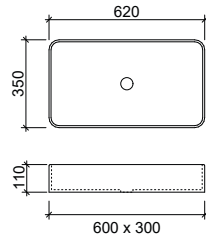

Charm

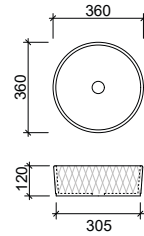

Diamond

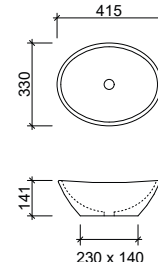

Elite

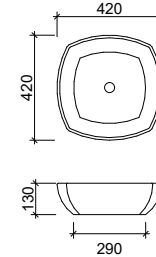

Evolve

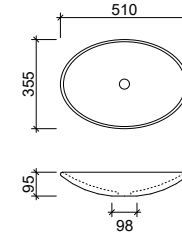

Feather

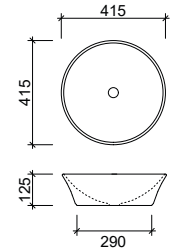

Flair

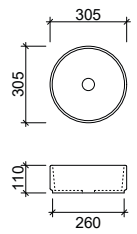

Gem

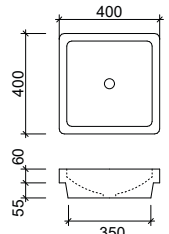

Modex

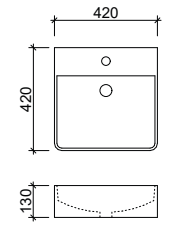

Iconic 420
With Overflow and
Tap Landing

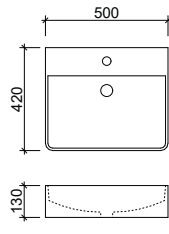

Iconic 500
With Overflow and
Tap Landing

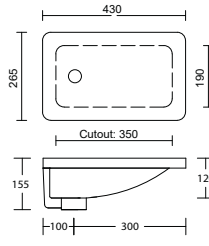

Mini Rectangle
Undermount
Overflow to Side

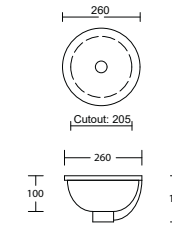

Mini Round
Undermount
Overflow to Front

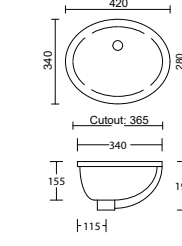

Oval Undermount
Overflow to Front

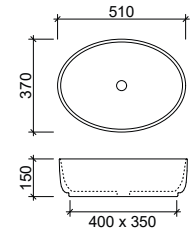

Plume

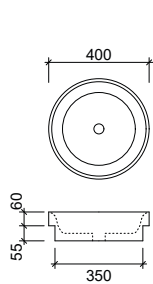

Radius

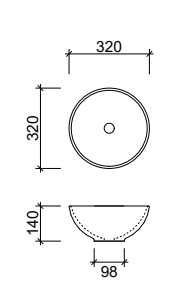

Rose

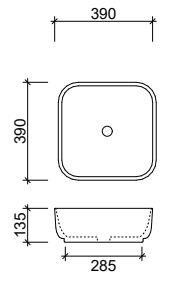

Surreal

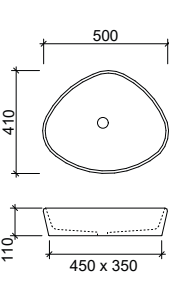

Swish

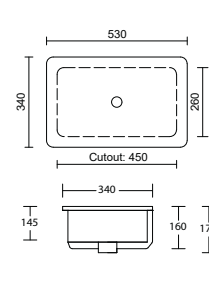

Rectangle Undermount
Overflow to Back

Waste Size: 32mm. **Overflow to:** All Undermount.
Evolve, Radius, Modex, Surreal, Flair, Plume &
Swish require offset tap hole or taps from wall.

Waste size: Acrylic = 40mm, Ceramic = 32mm, Sculptured Marble = 32mm
Note: Where left or right hand options are available please specify or else cabinets will be supplied as per these drawings.
NOTE: All vanity top and basin sizes are nominal only. E&OE

